

Now offering Colonial Teak Building

In 1935, in Kudus (Koedoes), Java, Dutch merchant H.M. Muslich constructed a warehouse (gudang) for his sprawling kretek cigarette factory, the Pabrik Rokok Delima, a popular brand of kretek cigarettes at the time.

This stunning 2 story building, 12 meters wide, 45 meters long and 8 meters to the ridge, is constructed entirely of the best quality Javanese Teak available at the time. It is all dense, old growth wood with almost no sapwood and few knots. The largest beams, the mezzanine girders, measure an amazing 18 cm x 28 cm x 540 cm long. It features beautifully turned support posts 25 cm in diameter, spectacular trusses with hand forged steel fittings, two spectacular massive staircases and solid teak doors and windows crafted for strength, utility and aesthetics.



During disassembly and before restoration.



During disassembly and before restoration.



During disassembly and before restoration.

In late 2009, we carefully dismantled the entire building by hand and transported to our warehouse on Bali.



sam@earthwisebali.com +62 81 237 031 178 shri@earthwisebali.com +62 81 236 404 90
www.earthwisebali.com



It is currently undergoing the process of being lovingly restored and prepared for re-erection. It is being sanded and oiled to a lustrous, deep golden finish that is unique to old teak.

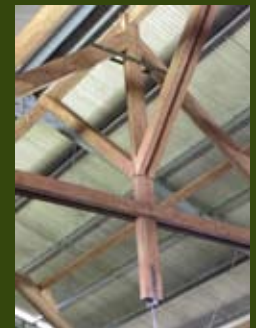

Undergoing restoration in our warehouse.

The building can be re-erected in a variety of configurations. It is a post and truss structure with a self supported mezzanine as the second story, a tremendously versatile structure.

A single story open roof plan is possible as well as a two story structure. One of the most versatile configurations would be a partial open roof plan with a loft / mezzanine. It can be re-constructed with or without in filled walls or with some sides enclosed and others left open. It would be a magnificent private Vila or a commercial building such as a restaurant, or a hotel / resort anchor reception area.



Ready to view in our Bali warehouse.



Purchase Options

We are offering the entire building for sale with the following options:

Option 1:

Purchase of the entire inventory of wood components. All wood sanded and oiled. No joints or decay repaired / replaced. Price: USD \$395,000.

Option 2:

Purchase of the entire building, all joints and decay repaired / replaced, in kit form, ready for re-assembly with plans and engineering. Price: USD \$525,000.

The quantity of prime teak lumber in the structure is 55 cubic meters / 23,000 board feet. The value of the lumber alone makes this building a solid investment opportunity.

You can visit this project in our warehouse in Batuan, Bali, Indonesia
Serious inquiries only, please.



For information and appointment:

sam@earthwisebali.com +62 81 237 031 178

shri@earthwisebali.com +62 81 236 404 90

www.earthwisebali.com